

2008 TRAFFIC VOLUMES
MUNICIPALITY OF
MONTICELLO
 PREPARED BY THE
MINNESOTA DEPARTMENT OF TRANSPORTATION
 OFFICE OF TRANSPORTATION DATA & ANALYSIS
 IN COOPERATION WITH
U.S. DEPARTMENT OF TRANSPORTATION
 FEDERAL HIGHWAY ADMINISTRATION

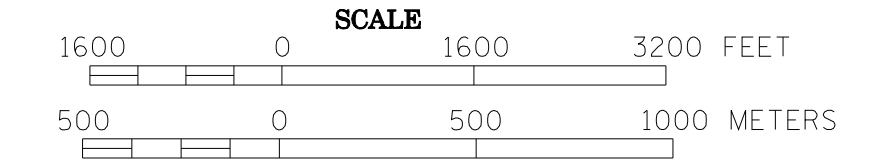

2008
 BASIC DATA - 1991

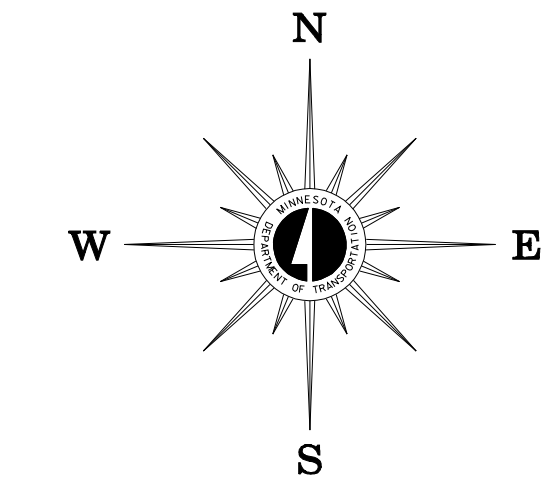

LEGEND

- INTERSTATE TRUNK HIGHWAY..... (I-95)
- U.S. TRUNK HIGHWAY..... (10)
- STATE TRUNK HIGHWAY..... (55)
- COUNTY STATE AID HIGHWAY..... (21)
- COUNTY ROAD..... (14)
- CORPORATE LIMITS.....
- PUBLIC ROAD.....
- PRIVATE ROAD.....

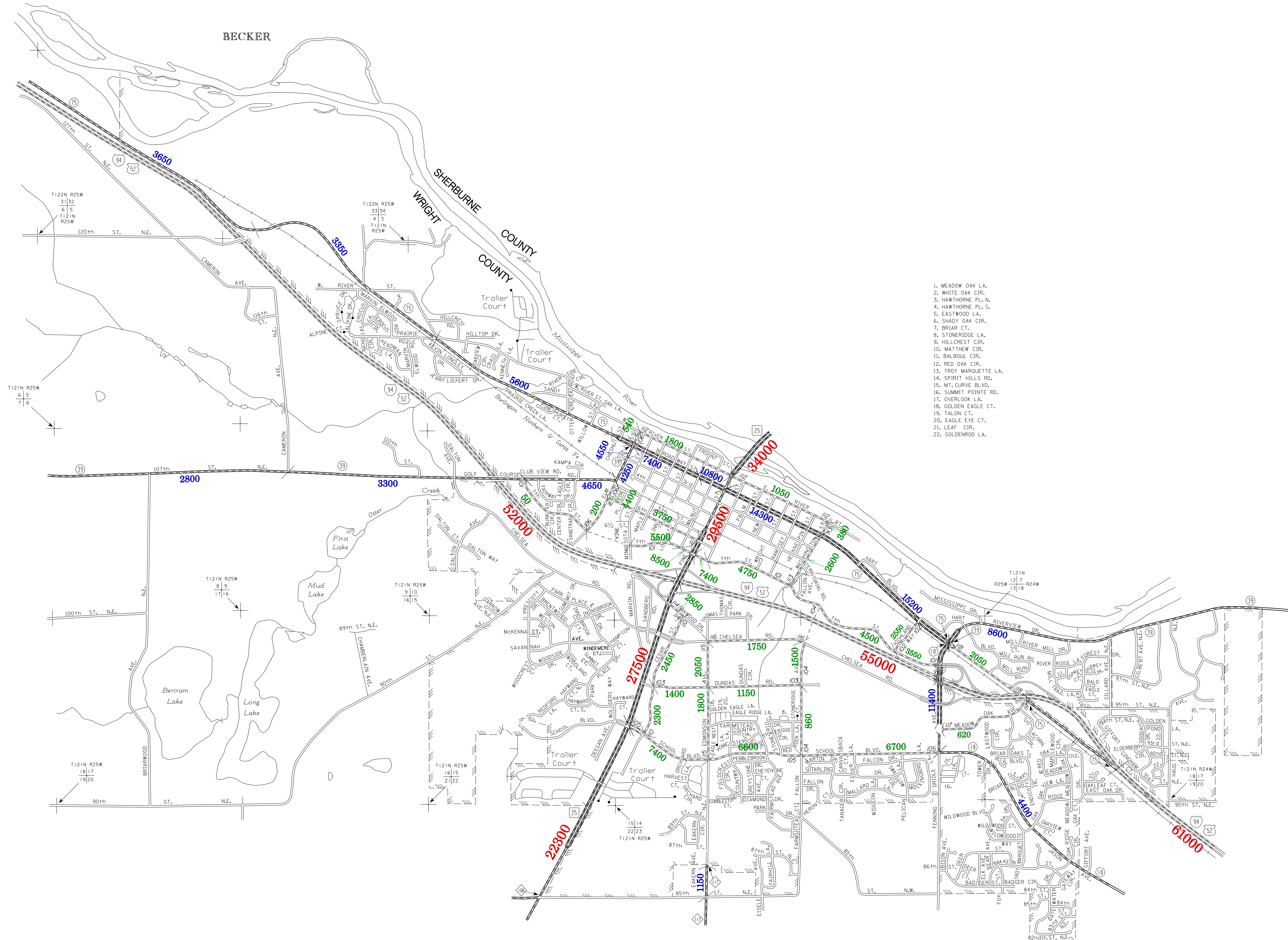

1. MEADOW OAK LA.
2. WHITE OAK CIR.
3. HAWTHORNE PL. N.
4. HAWTHORNE PL. S.
5. EASTWOOD LA.
6. SHADY OAK CIR.
7. BRIAR CT.
8. STONERIDGE LA.
9. HILLCREST CIR.
10. MATTHEW CIR.
11. BALBOUL CIR.
12. RED OAK CIR.
13. TROY MARQUETTE LA.
14. SPIRIT HILLS RD.
15. MT. CURVE BLVD.
16. SUMMIT POINTE RD.
17. OVERLOOK LA.
18. GOLDEN EAGLE CT.
19. FALCON CT.
20. EAGLE EYE CT.
21. LEAF CIR.
22. GOLDENWOOD LA.

MUNICIPAL STATE AID STREET SYSTEM

LEGEND

- MUNICIPAL COUNTY STATE AID STREET.....
- MUNICIPAL STATE AID STREET.....
- COUNTY STATE AID HIGHWAY.....
- COUNTY ROAD.....
- TRUNK HIGHWAY.....

VOLUMES PREPARED BY
 THE OFFICE OF
 TRANSPORTATION DATA & ANALYSIS

NUMERALS INDICATE AVERAGE DAILY
 TRAFFIC VOLUMES ON DESIGNATED ROADS.

TRUNK HIGHWAY ROUTES ARE 2008 A.A.D.T. VOLUMES
COUNTY SYSTEM ROADS ARE 2008 A.A.D.T. VOLUMES
MUNICIPAL STREET ROUTES ARE 2008 A.A.D.T. VOLUMES

FOR DESIGNATED ROADS :
 / = SEGMENT ENDPOINT FOR ALL
 ROADS INTERSECTED BY HATCH
 (= SEGMENT ENDPOINT ONLY FOR
 ROAD SEPARATED FROM INTERSECTING
 ROAD BY ARC

TRAFFIC VOLUMES ARE SUBJECT TO VARIABILITY AND CONSTRUCTION EFFECTS

FOR MORE INFO VISIT: <http://www.dot.state.mn.us/traffic/data/html/aadt.html>